

# Fulflo® EB Single Bag Filter Vessel

304 stainless steel, commercial  
(non ASME code) design

The Fulflo EB non ASME code single bag filter vessels provide economical filtration of a wide variety of liquids in a lightweight, externally polished stainless steel design, with features including a swing bolt secured, quick opening cover and an internal positive pressure bag hold down device.

EB single bag vessels accommodate one #2 (double length) Parker "G" style bag with a 7" diameter rim.

These vessels are manufactured from polished and passivated 304 stainless steel and rated for 150 psi (10.3 bar).

For added corrosion resistance, all cover bolt and leg mounting hardware is made from stainless steel as well.



## Contact Information

Parker Hannifin Corporation  
**domnick hunter**  
**Process Filtration - North America**  
2340 Eastman Avenue  
Oxnard, California, USA 93030

toll free +1 877 784 2234  
phone +1 805 604 3400  
fax +1 805 604 3401  
dhpsales.na@parker.com

[www.parker.com/processfiltration](http://www.parker.com/processfiltration)

## Benefits

- Swing bolted o-ring closure seal provides quick & positive seal with easy access to the vessel interior and filter bag
- Both FNPT threaded and ANSI B16.5 flanged connections are available in specific models
- NPT option offers dual 2" outlet ports on bottom and side locations
- EPDM seals are standard with other material options available
- Standard threaded FNPT vent & drains
- Standard stainless steel closure bolt hardware
- Polished exterior & pickle passivate interior/exterior for enhanced corrosion resistance
- Mounting legs are adjustable, providing flexibility for installation height and orientation

## Applications

- Potable Water
- Cutting Oils
- Solvents
- Coolants
- Process Water
- Coatings
- Lubricant

# Fulflo® EB Single Bag Filter Vessel

Material of Construction	Max. Allowable Pressure (MAP) (psi @ MAT °F)	Max. Allowable Temp. (MAT) (°F @ MAPpsi)
304 Stainless	150 psi (10.3 bar)	300°F (149°C)

O-ring Temperature Guide	
Material	Max. Temp.
Nitrile (Buna-N)	250°F (121°C)
EPDM (EPR)*	300°F (149°C)
FKM (Viton®)	400°F (204°C)

\*EPDM o-ring is standard.  
O-rings installed under the cover and under the basket rim.

## Typical Aqueous Flow 160 gpm\*

\*Based on 160 gpm water per #2 double bag

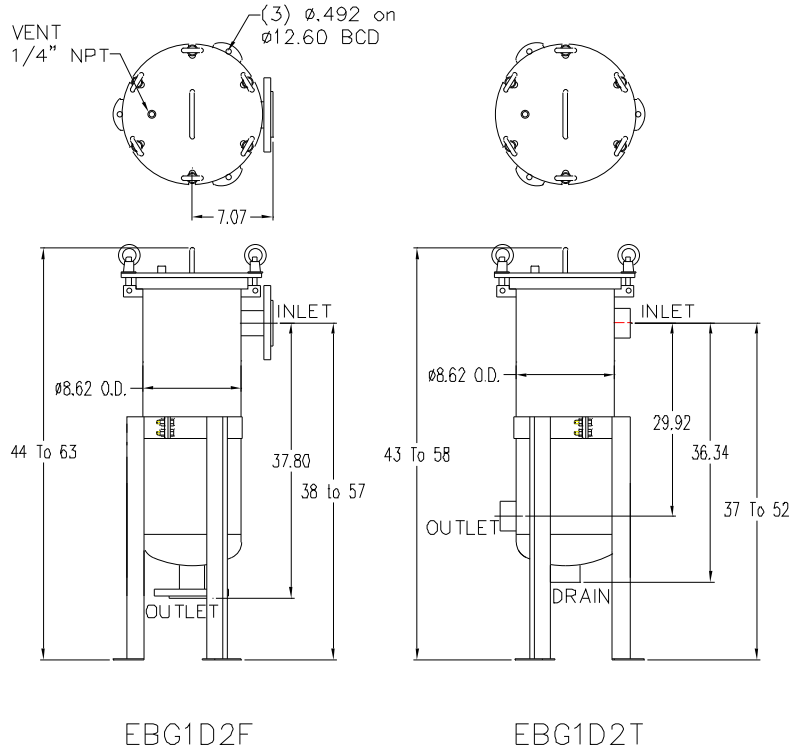

## Ordering Information

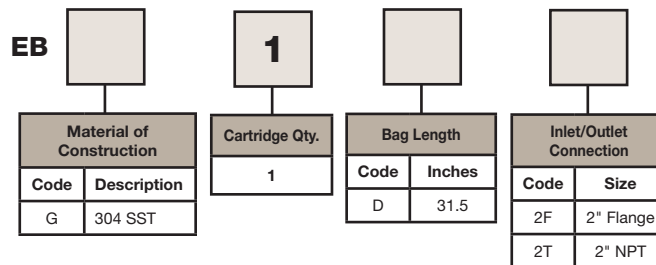

Specifications are subject to change without notification.  
For User Responsibility Statement, see [www.parker.com/safety](http://www.parker.com/safety)



© 2014 Parker-Hannifin Corporation  
domnick hunter Process Filtration - North America  
All Rights Reserved  
Fulflo is a registered trademark of Parker-Hannifin Corporation  
Viton is a registered trademark of E.I. DuPont de Nemours & Co., Inc.

DS\_IP\_EB Single Bag Vessel 2/14 Rev. A